

EMBRACING OCCUPATION SUPPORTING ALL PEOPLE POPULATIONS, AND COMMUNITIES

FOTA19: NOV. 16-17
ORLANDO, FLORIDA

FOTA
Florida Occupational Therapy Association



Thank you to our FOTA19 Sponsors:



**AMERICAN THERAPY
ADMINISTRATORS OF FLORIDA**





Pursue a degree in the field of Occupational Therapy

Train for a career as an Occupational Therapy Assistant at South University, with hands-on training, one-on-one mentoring, and an experienced* faculty that's invested in you. On-campus and hybrid schedule options available.

Apply today.

888.444.3404 | SouthUniversity.edu



Proud sponsor of the **Florida Occupational Therapy Association**

Programs, credential levels, technology, and scheduling options vary by school and are subject to change. Not all online programs are available to residents of all U.S. states. Administrative office: South University, 709 Mall Boulevard, Savannah, GA 31406-4805. ©2019 South University. All rights reserved. Our email address is materialsreview@southuniversity.edu.

*Credential and experience levels vary by faculty and instructors.



Florida Occupational Therapy Association

PRESIDENT Douglene Jackson, PhD, OTR/L, LMT, ATP
VICE PRESIDENT Debra Misrahi, DrOT, OTR/L
TREASURER Jordan Powers, OTD, OTR/L
SECRETARY Elise Bloch, Ed.D., OT/L

STANDING COMMITTEE CHAIRS
GOVERNMENTAL AFFAIRS
 Kelly Uanino, OTRL, CLT-LANA
 Sharon Rosenberg, MS, OTR/L
LEADERSHIP DEVELOPMENT
 Michael Steinhauer, OTR/L, MPH, FAOTA
 Nadya Ramos Hernandez, COTA, OTD
REGIONAL REPRESENTATIVES
 Dana Dixie, OTR/L
MEMBER CONCERNS
 André Johnson COTA/L, BHS
PRACTICE SIS
 Ricardo Carrasco, PhD, OTR/L, FAOTA
CONFERENCE CONVENER
 Tia Hughes, DrOT, MBA, OTR/L

AOTA REP (FL)
 Dr. Edwin Myers, OTD, OTR/L

SIS CHAIRS
ADMINISTRATION
 Michael Steinhauer, OTR, MPH, FAOTA
DEVELOPMENTAL DISABILITIES
 Maria Pilar del Saa, OTD, OTR/L

EDUCATION
 Kurt Hubbard, PhD, OTD, OTR/L, FAOTA

FIELDWORK EDUCATION
 Linda Struckmeyer, PhD, OTR/L

GERONTOLOGY
 Anjali Parti, OTD, OTR/L
 Annette Bullard, OTA/L, BA, AFWC

HEALTH PROMOTIONS AND WELLNESS
 Marcia Hamilton, OTD, MSHS, OTRL, BCP

HOME & COMMUNITY
 Amanda Kotolski, PhD, OTR/L

MENTAL HEALTH
 Martha Montejo-Whaley, PhD, OTR/L

OCCUPATIONAL SCIENCE
 Ricardo C. Carrasco, PhD, OTR/L, FAOTA

PHYSICAL DISABILITIES
 Kristin Domville, MOT, OTR/L

RESEARCH CO-SIS
 Annemarie Connor PhD, OTR/L
 Sarah Fabrizi PhD, OTR/L

SCHOOL SYSTEMS
 Kim McKinney, MPT, MOT, OTR/L

SENSORY INTEGRATION
 Gustavo A. Reinoso, PhD, OTR/L

TECHNOLOGY
 Rick Davenport, PhD, OTR/L

WORK PROGRAM
 Regina Bonyng, OTR/L, CWCE, CEAS

REGIONAL REPRESENTATIVES
REGION 1: NORTHWEST
 Open

REGION 2: CAPITOL
 Sylvia Young, OTR/L

REGION 3: NORTH CENTRAL
 Heidi Horwitz, OTR/L

REGION 4: NORTH EAST
 Julie Watson, PhD, OTR/L

REGION 5: CENTRAL EAST
 Karen Snyder, PhD, OTR/L

REGION 6: SOUTH EAST
 Lindsey Demetres, MSORT/L

REGION 7: SOUTH
 Stephanie Carlo, MS, OTR/L

REGION 8: SOUTH WEST
 Shannon Miller, COTA/L, CSRS

REGION 9: CENTRAL WEST
 Dana Dixie, OTR/L

PRESIDENT'S WELCOME

Welcome to the annual conference of the Florida Occupational Therapy Association (FOTA). We thank you for supporting this year's conference as we provide you with professional development and networking opportunities.



Embracing Occupation: Supporting all People, Populations, and Communities is the theme for #FOTA2019! We return to Orlando this year with new days, hosting the conference over Saturday and Sunday. We have tailored educational sessions, posters, conversations that matter, meetings, fitness, and networking throughout these days to meet the needs of the varied audience in attendance: occupational therapists, occupational therapy assistants, students, and others. Building upon last year's theme, we aim to provide you with continuing education opportunities to advance your practice and translate knowledge faster. Our goal is to enhance your knowledge and skills by keeping you abreast of evidence-based practice, research, and advocacy, as well as provide you with practical tools, resources, and information to apply to your everyday practice. Required continuing education for license renewal are again offered this year, along with many topics to meet the needs of occupational therapy practitioners and students.

We thank our Conference Team for #FOTA 2019, as this would not exist without their expertise and efforts. A special thanks to Tia Hughes, Conference Convener, Debbie Misrahi, FOTA Vice President, and Janine Silvaroli, FOTA Association Coordinator, who have orchestrated all aspects of #FOTA 2019. We acknowledge our volunteer coordinator and the many volunteers who have also assisted behind the scenes and throughout the conference to provide you with a quality experience. We also thank our sponsors and exhibitors, FOTA leadership, and members who support our efforts. Be sure to join us for the Annual FOTA Business Meeting and Awards Ceremony, visit the exhibition hall, participate in the fun run, and attend the mix and mingle!

We thank you for attending and look forward to you joining FOTA, continuing your membership, and being active as we advocate for our consumers and profession! Your membership and service matter!

Regards,
 Douglene Jackson, PhD, OTR/L, LMT, ATP
 FOTA President

Saturday, November 16

Registration Open 7 am - 5 pm in EXHIBITION HALL
EXHIBITION HALL 8 am - 4 pm

	OCEANS 1-3	OCEANS 4	OCEANS 9	OCEANS 10	OCEANS 11	OCEANS 12	VEILTAIL	TARPON A/B
8:00	WS-1 Introduction to Pediatric UE and Hand Therapy		WS-2 Assess & Treat of UE Nerve Entrapment: Beyond Carpal Tunnel Syndrome	WS-3 Impact of Pre-discharge Home Assess Visits for Stroke Patients	WS-4 From Dependence to Independence with Scleroderma	WS-5 Embracing Occupation for Individuals with Cognitive Deficits		CTM-1 Executive Order & OT Implications for Veteran Suicide Pt.2
9:00		Student Poster 1 Setup/Judge						CTM-2 Best Practices for Supporting the LGBTQ+ Community
9:30								
10:00		Student Poster 1 Presentation	SC-1 I See You! Low Vision in Older Adults	SC-2 Surgical Scars: Their Influence on Pain and Health	SC-3 Innovative and Collaborative Level I Fieldwork Experiences	SC-4 Improving Visibility in Home Health	SC-5 Mentorship experiences of Occupational Therapists who have attained certification in Hand Therapy	CTM-3 Is Cyberbullying an Occupation?
11:00	FOTA WELCOME & KEYNOTE SPEAKER (Oceans 1-3)							
12:00	LUNCH BREAK: Oceans 5-8							
12:30	Stop by the exhibition hall and visit our vendors							
1:00		Professional Poster Session 1	SC-6 Guidelines for Billing and Reimbursement for Private OT	SC-7 Community Partnership to Support Caregivers of Alzheimer's	SC-8 Aromatherapy for the OT Practitioner	SC-9 Advancing your Practice for Intervention with Autism Using a Communities of Practice Model		SC-10 SOTA LEADERSHIP
2:00	WS-6 Medical Errors	Student Poster 2 Setup/Judge	WS-7 Amplitude Training: A Treatment Approach for Consumers Living with Parkinsonisms	WS-8 Pressure Injury Prevention & Interventions for Effective Outcomes	WS-9 Making Metrics Matter: Strategies Utilizing Metrics to Maximize Productivity & Reimbursement	WS-10 Printing: Focus on Size Form will Follow	WS-11 Edema & Lymph Management - using OT skills for Functionality	CTM-4 Occupational Burnout
2:30								CTM-5 Student Accommodations on Fieldwork
3:00								
4:00	Stop by the exhibition hall and visit our vendors							
4:30		Student Poster 2 Presentation	SC-11 Supporting college students w/ LD & ADD	SC-12 Roadmap for Disaster Preparedness	SC-13 Back to Mental Health Fieldwork II Experience	SC-14 3D Printing in the Rehab Clinic		CTM-6 Research Validating OTs as Qualified Mental Health Providers
5:30	MIX & MINGLE 5:45 (Atrium Lounge)							

Sunday, November 17

Fun Run 6:30 am hotel entrance
Registration Open 7 am - 5 pm in EXHIBITION HALL
EXHIBITION HALL 8 am - 4 pm

	OCEANS 1-3	OCEANS 4	OCEANS 9	OCEANS 10	OCEANS 11	OCEANS 12	UNICORN	TARPON A/B
8:00	SC-15 Aging in Place		SC-16 OT & Vision Impair in School System	SC-17 Medicare Coverage of Maintenance Therapy	SC-18 Let's Talk about the NBCOT® National Certification Exam!	SC-19 OT Cardiac Rehab		CTM-7 Off the Shelf Gaming for OT
9:00	WS-12 Laws & Rules	Student Poster 3 Setup/Judge	WS-13 Next Gen OTs Crushing Your Career Goals	WS-14 Effective Treatment Approaches to Subluxation	WS-15 Multidisciplinary Approach to Concussion	WS-16 Admin. Interpr & Implementation of the Cognitive Perform Test	WS-17 New Assessment to Capture Observations in Sensory Integration	CTM-8 Insurance Fraud & Unethical Billing
9:30								CTM-9 OT & Cancer Care
10:00		Student Poster 3 Presentation						
11:00	FOTA MEMBERSHIP MEETING & AWARD CEREMONY							
12:00	LUNCH BREAK: Oceans 5-8							
12:30	Stop by the exhibition hall and visit our vendors							
1:00		Professional Poster Session 2	SC-20 Perspectives on Home Modifications & the Utility of Repurposing	SC-21 Adaptive Sports and Rec as Therapeutic Occupation	SC-22 Assessing Student Clinical Skills via Simulations	SC-23 Enhancing Quality of Life for clients with dementia and their caregivers		CTM-10 Trauma & Trauma Informed Approach to Care
2:00	Student Poster Awards & FLOTEC Educator of the Year Awards		WS-18 Incorporating Evidence Based Practice into your Fieldwork experiences	WS-19 Best Practices within OT for the LGBTQ Community	WS-20 Skilled Maintenance How to Identify the Need and Document the Skill	WS-21 Starting a Niche Emerging Practice 101 Steps to Plan, Market & Grow		CTM-11 Mentor Role: Develop Prof. Behaviors in Students
2:30								
3:00	SC-24 Patient Decision Aids & Personal Decision Guides							



www.facebook.com/Florida-Occupational-Therapy-Association-76909003677/

twitter.com/FLOTEAssn

www.instagram.com/fota_ot/



Fun Run

Sunday, Nov. 17
at 6:30 AM

Meet FOTA representatives
in the lobby

OCCUPATION IS UNIVERSAL

LESSONS FROM THE GLOBAL CLASSROOM



**FOTA19
KEYNOTE SPEAKER**
JOAN SURFUS, OTD, OTR/L, SWC

Ready for an adventure? Join our keynote speaker to hear about her journey from a young OT who loved traveling to an international speaker and educator. Hear how her love of culture and children created an opportunity for global travel and provided her lessons for the clinic back home.

Joan Surfus, OTD, OTR/L, SWC has been practicing in pediatrics for over 25 years. She received her bachelor's degree from Western Michigan University and her master's and Clinical Doctorate from Misericordia University. Dr. Surfus is the Clinical Coordinator of Occupational Therapy and the feeding specialist at Pediatric Therapy Network in Torrance, California and an Adjunct Assistant Professor of Clinical Occupational Therapy in the USC Mrs. T.H. Chan Division of Occupational Science and Occupational Therapy. Her focus has been in pediatric intervention with an emphasis in sensory integration, feeding, oral-motor and dysphagia, and autism spectrum disorders. Dr. Surfus is certified to administer and interpret the Sensory Integration and Praxis Test (SIPT) and a prior instructor for USC/WPS Sensory Integration Certification Program and current instructor for the Chan USC Sensory Integration Certification. She teaches regularly in these areas both nationally and internationally. Dr. Surfus spends her free time volunteering abroad, providing services for children with special needs and training staff at a school in Honduras. She also provides volunteer teaching and training in Russia with Naked Heart Foundation.

SCHEDULE AT A GLANCE

Saturday, November 16

7 am Registration
 8 am - 11 am Education Sessions
 9 am Student Poster Session 1
 11 am Welcome & Keynote Address
 12 pm Lunch
 1 pm - 5:30 pm Education Sessions
 1 pm Professional Posters
 2 pm Student Posters 2
 5:45 pm Mix & Mingle

Sunday, November 17

6:30 am Fun Run
 7 am Registration
 8 am - 11 am Education Sessions
 10 am Student Poster 3
 11 am Membership Meeting
 & Award Ceremony
 12 pm Lunch
 1 pm - 3 pm Education Sessions
 1 pm Professional Posters
 2 pm Student Poster Awards
 & FLOTEC Educator of the Year Awards
 4 pm Conference concludes



Join the network that's as dedicated as you are.

ATA of Florida knows what's most important to you. Its not paperwork, chasing payments, or justifying treatment. **It's Care.**

Our unique approach has helped us grow to more than 3,200 in network therapists. Our foundation is our skilled application of the case-rate methodology. Our patient-centric approach is actually provider-centric too. It is designed to maximize the amount of authorized time you spend with your patient, while minimizing the administrative burden to do so.



We have a 90% satisfaction rate and we've enjoyed provider retention of 95%



**Leading health plans
we work with:**



NO FEE to join or for any of our services.

Join our network at: www.ataflorida.com/join or by calling us at: **1 (888) 550-8800**



CONCORDE CAREER INSTITUTE

Located in South Florida, Concorde is training the next generation of Occupational Therapy Assistants.

To learn more about our qualified graduates or to become a partner, please give us a call!

Call Concorde at 954-731-8880!



10933 Marks Way | Miramar, FL 33025

MEMBERSHIP WORKS!



Florida Occupational Therapy Association

- Legislative advocate for OT practitioners and our clients
- Professional Networking
- Continuing Education
- Consumer Support and Resources
- Discounts on FOTA Conferences
- Student Membership to help new graduates transition to professionals

VISION

FOTA is the respected authority on occupational therapy's contribution to health and well being in Florida

MISSION

FOTA members support and develop the best practice of occupational therapy to advance the profession and better serve our consumers.

PRACTICE EDUCATION ADVOCACY

RAFFLE TICKETS

WIN a year's
FOTA Membership
and FREE
#FOTA20 Registration!



**Purchase at
FOTA Booth**



Florida Occupational Therapy Association

Saturday, November 16, 2019
Sunday, November 17, 2019
Renaissance Orlando at SeaWorld®
6677 Sea Harbor Drive
Orlando, FL 32821

Vision

FOTA is the respected authority on occupational therapy's contribution to health and well being in Florida.

Mission

FOTA members support and develop the best practice of occupational therapy to advance the profession and to better serve our consumers.

www.flota.org

WIFI: FOTA19
Password: community

2019 Annual Conference
Continuing Education (CE)
Certificate Policy

You must attend an entire session to earn Continuing Education (CEs).

Your attendance certificate is a two-part, carbonless NCR form available at the registration desk. Write your name, Florida OT/OTA license number and the name of the session(s) that you attend.

Attendance will be verified at each session by a host who will initial the form indicating the session you are attending.

At the end of the conference, total the CE hours of the sessions that you attended and enter on the form. Sign the form and return the yellow copy to the conference registration desk. Secure the white copy in your records for at least four years.

Ensure that your name, license number and total hours of CEs are correct. FOTA will not process any certificate without the practitioner's correct Florida OT/OTA license number.



FOTA is a state affiliate of the American Occupational Therapy Association.

WS-1
Sat. 8 AM
OCEANS 1-3

INTRODUCTORY PHYSICAL DISABILITIES

Introduction to Pediatric Upper Extremity & Hand Therapy
Erin Davis, MS, OTR/L
Emalie Styles, MOT, OTR/L

Therapists face unique challenges when working with orthopedic issues in children and young adults. This workshop will cover basic principles of hand function/development, introduce participants to commonly presenting conditions (both congenital and acquired), and describe strategies for evaluation and therapeutic intervention. OBJECTIVES: Describe orthopedic development and hand function milestones in children and young adults. Recognize features of commonly presenting pediatric conditions that impair occupational performance. Describe general guidelines for intervention process, including indications for the use of physical agent modalities and/or orthotic management.

WS-2
Sat. 8 AM
OCEANS 9

INTERMEDIATE PHYSICAL DISABILITIES

Assessment and Treatment of Upper Extremity Nerve Entrapment: Beyond Carpal Tunnel Syndrome
Laura Conway, OTR/L, CHT, COMT UE

Nerve entrapment is one of the most common conditions in upper extremity rehabilitation. Clinicians are familiar with carpal tunnel syndrome, it's presentation and treatment. This course will explore beyond CTS, examining points of median, radial, ulnar, and supra-scapular nerve entrapment. We will review presentation, causation, evaluation and treatment. OBJECTIVES: Be able to identify the objective signs of UE nerve entrapment. Become familiar with provocative maneuvers to assess UE nerve entrapment. Gain an understanding of prevention and treatment of UE nerve entrapment

WS-3
Sat. 8 AM
OCEANS 10

INTERMEDIATE PHYSICAL DISABILITIES

Impact of Pre-discharge Home Assessment Visits on Discharge Preparedness of Stroke Patients
Becky Piazza, OTD, MS, OTR/L, BCPR

A pre-discharge home assessment visit was implemented to determine its impact on perceived discharge preparedness for clients with stroke and their caregivers prior to discharge from an inpatient rehabilitation facility. This intervention promoted goal planning, shared decision making, and a client identified trajectory for stroke recovery. OBJECTIVES: Summarize the literature that speaks to the effectiveness of discharge readiness and success when a home evaluation is part of post-acute rehab treatment plan for clients after stroke. Discuss inpatient rehab facility (IRF) planning and quality improvement project implementation to ensure consistent interdisciplinary best practice to support successful discharges and positive outcomes with clients after stroke. Identify home evaluation assessments and how one inpatient rehab facility translated the literature into an inpatient rehab specific occupational therapy led pre-discharge home assessment visit best practices. Review outcome measures associated with pre and post pre-discharge home visit assessment surveys to capture client and caregiver perceptions of occupational therapy interventions. Discuss motivational interviewing and outcomes associated with the use of the COPM with clients and caregivers as a part of occupational therapy interventions for discharge planning. Provide education on aligning hospital policy, CARF standards, and documentation in the EMR. Discuss coordination of billing behaviors across disciplines to accurately reflect skilled services being delivered (CDM)

WS-4
Sat. 8 AM
OCEANS 11

INTERMEDIATE PHYSICAL DISABILITIES

From Dependence to Independence with Scleroderma
Cheryl Albright, OTR/L, C-IAYT
Lori Pierce, RYT

This presentation will cover the etiology of scleroderma, current research and trends, what is essential for some-one patients with scleroderma need to have in their home exercises programs, modifications to everyday life tasks, contraindications, and the occupational journey from complete dependence to independence. OBJECTIVES: Basic understanding of scleroderma etiology and its impact on occupational performance. Role occupational therapists have in the treatment team for persons with scleroderma. Simple and inexpensive modifications to improve ADL/IADL independence

WS-5
Sat. 8 AM
OCEANS 12

INTERMEDIATE GERONTOLOGY

Embracing Occupation with Designing Activity and Wellness Programs for Individuals with Cognitive Deficits
Angela Edney, MSA, OTR/L

This presentation will include information on using a collaborative approach that will facilitate individuals with impaired cognition to live an active full life. Participants will learn about tools that can be utilized to develop failure-free programs for clients with mild, moderate, and severe cognitive impairment. OBJECTIVES: Articulate how team members can work together to develop wellness programs for individuals with cognitive impairment with specifics on the role and value of occupational therapy. Identify various tools that can help develop optimal wellness programs for patients with cognitive impairment based on the patient's cognitive level. State the various options/strategies for failure-free programming and anticipated outcomes.

WS-6
Sat. 2 PM
OCEANS 1-3

INTRODUCTORY GERONTOLOGY

Medical Errors
Debra Chasanoff MEd, OTR/L

This program was designed to meet the criteria in Section 456.013(7), Florida Statutes, which mandates that two hours of continuing education in medical errors prevention is required for licensure renewal in Florida. OBJECTIVES: Be able to identify how to apply a systems approach to identify and reduce the risk for medical errors in the clinical environment to improve patient safety.

WS-7
Sat. 2 PM
OCEANS 9

INTERMEDIATE GERONTOLOGY

Amplitude Training: A Treatment Approach for Consumers Living with Parkinsonisms
Carlos Martoral, OTD, JD

This Workshop is designed to offer clinicians an evidence-based treatment approach (amplitude training) for clients with Parkinsons Disease related impairments. Treatment using LSVT BIG principles has demonstrated significant functional improvements within this population. Program includes participation in an amplitude exercise regimen. OBJECTIVES: Identify clients who might benefit from amplitude training. Evaluate the purpose of amplitude training and expected benefits. Demonstrate exercises designed to promote increased amplitude of movement.

WS-8
Sat. 2 PM
OCEANS 10

INTERMEDIATE PHYSICAL DISABILITIES

Pressure Injury Prevention Interventions for Effective Outcomes
Krista Mackenzie, OTR/L
Mike Chiarelli, PT, DPT

This workshop will review anatomy of the skin and staging of pressure injuries, discuss a literature review on effective pressure injury prevention with the SCI population, education on pressure mapping, managing pressure across various positioning environments and education on positioning and cushion selection as well as funding options for equipment. OBJECTIVES: Review anatomy of skin and staging of pressure injuries. Educate on wheelchair positioning and cushion selection for preventative care and funding options. Observe a live demo of pressure mapping and how pressure changes across various positioning environments

WS-9
Sat. 2 PM
OCEANS 11

INTERMEDIATE ADMN-MGMT

Making Metrics Matter: Strategies ffor Utilizing Metrics to Maximize Productivity & Reimbursement
Brandon Seigel, CRP

What would happen if our cars did not have fuel gauges? Metrics can be utilized as a "GPS." OBJECTIVES: Be able to identify strategies for solving employee performance problems through employee empowerment techniques. Be able to create a roadmap for success in holding your team more accountable without burning them out! Be able to identify strategies to align employee's personal and professional goals with key performance indicators for your private practice.

WS-10
Sat. 2 PM
OCEANS 11

INTRODUCTORY SCHOOL SYSTEMS

Printing: Focus on Size. Form will Follow.
Beverly Moskowitz, DOT MS OTR/L FAOTA

Letter Size proves to be the variable impacting legibility most. With only 3 sizes (vs 62 forms), correcting errors in Letter Size makes an immediate, visible & measurable difference in the consistency & readability of the written page. SMHP supports Best Practice & Rtl as its concepts and strategies enable collaboration within the classroom. OBJECTIVES: Explain, recite, instruct & score Letter Size (& spacing, the second most important variable!) according to "The Rules"™ Recall & describe 2-3 ways SMHP can be embedded across all content areas, including Push-in, Centers, Handwriting Club, as a full curriculum and for Rtl. Identify the Key Concepts, main focus & sequence for instruction in the Size Matters Handwriting Program.

WS-11
Sat. 2 PM
VEILTAL

INTERMEDIATE GERONTOLOGY

Edema and Lymphedema Management – Using Occupational Therapy Skills to Address Issues withFunctionality
Perna Poojary Mazzotta, PhD, OTR/L, CLWT
Bryan Groleau, COTA/L, CLT-LANA, CLWT, WCC, LLE

Addressing lymphedema and edema is important to prevent disease progression, manage complications and avoid further physiological damage. OBJECTIVES: Clinicians will understand edema and/or lymphedema management skills while articulating and discussing various differences between compression products to effectively manage edema and/or lymphedema. Define lymphedema different from edema when presented as a secondary diagnosis or coexisting condition to the primary diagnosis and prioritize the

plan of care accordingly. Demonstrate an entry level understanding of the various compression products for lymphedema Formulate plan of care management strategies that target the primary diagnosis while monitoring the lymphedema and preventing exacerbation while understanding differences in various compression products and their clinical effectiveness.

WS-12
Sun. 9 AM
OCEANS 1-3

INTRODUCTORY WORK PROBLEMS

Laws & Rules
Barbara Ingram Rice OT, CHC, CLT

Designed to meet Florida's requirement for a two-hour course on Laws and Rules, the session will teach participants how to find the Occupational Therapy Practice Act, its purpose and what it means. Participants will understand their obligations under OT licensure, including supervision, continuing education, reporting unlicensed activity and disciplinary actions, if found in violation.

WS-13
Sun. 9 AM
OCEANS 9

INTRODUCTORY WORK PROBLEMS

Next-Gen OT's: Crushing Your Career Goals!
Brandon Seigel, CRP

This presentation will provide a new perspective to students and help them best prepare for their first career position. OBJECTIVES: Students will walk away from this presentation with tangible skillsets inclusive of strategies for writing effective resumes, cover letters, and appropriate interview skills. Identify key health-care environment challenges impacting the Occupational Therapy profession. Identify key strategies for creating an effective "new grad OT."

WS-14
Sun. 9 AM
OCEANS 10

INTERMEDIATE GERON/PHY DISAB

Effective Treatment Approaches for Subluxation
Cindy Erb, OTD, MSH, OTR/L, CNDT, CLT

Subluxation following a CVA can be challenging, and unfortunately, many therapists treat a subluxation incorrectly. We will identify the neurological premise and theoretical base for treatment considerations and the sequence that will improve alignment, decrease pain, modulate tone, and restore volitional control/movement toward functional use. OBJECTIVES: Identify the neuro-developmental basis for the residual effects of CVA on posture, alignment, tone, volitional movement, and functional ability. Implement an effective, skilled treatment progression to resolve shoulder subluxation following CVA/neuro insult to support EBP with predictable results. Provide opportunity for participants to be a part of professional research by utilizing treatment progression protocol provided for future treatment of patients with shoulder subluxation.

WS-15
Sun. 9 AM
OCEANS 11

INTERMEDIATE OCCUP SCIENCE

Multidisciplinary Approach to Concussion: Occupational Therapy's Distinct Value through the Science of Everyday Living
Becky Piazza, OTD, MS, OTR/L, BCPR
Lisa Warren, MS, OTR/L

An evidence-based approach to post concussive evaluation and treatment will be presented which outlines direct clinical practice considerations grounded in occupational science and identity reconstruction within a multidisciplinary medical model of care. OBJECTIVES: Describe UF Health Normal Fixel Institute for Neurological Diseases multidisciplinary model of care: Biopsychosocial approach. Describe occupational therapies distinct value in post concussive care assessment

WORKSHOPS

and intervention. Outline conceptual frameworks utilized: PEOP, MOHO, Occupational Adaptation Demonstrate the effectiveness of the Cognitive Orientation to daily Occupational Performance Approach and use of guided discovery. Support an Occupational Science approach to post concussion occupational therapy practice: occupational performance, occupational disruption, occupational dysfunction, occupational deprivation. Examine Occupational Identity, Identity Reconstruction, and Occupational Competency as a key driver to client empowerment. Distinguish Occupational Therapy assessment and intervention utilized to establish a multidisciplinary plan of care identify implementation considerations for the delivery of multidisciplinary healthcare services.

WS-16
Sun. 9 AM
OCEANS 12

INTERMEDIATE
GERONTOLOGY

Administration, Interpretation and Implementation of the Cognitive Performance Test

Vicki Case, MS Ed. OTR/L

This course is designed for OT's and OTA's who work with persons with any kind of cognitive dysfunction.

Participants will gain a familiarity with the

Allen Levels and how to implement this model into clinical practice. Learn how to administer and interpret the Cognitive Performance Test which is associated with the Allen theory.

OBJECTIVES: Describe the six cognitive levels of function and the modes of performance that subdivide the levels. Perform the Cognitive Performance Test to evaluate cognitive level of function. Interpret and document the results of the Cognitive Performance Test.

WS-17
Sun. 9 AM
UNICORN

INTERMEDIATE
SENSORY INTEGRATION

A New Assessment to Capture Observations in Sensory Integration: The Structured Observations of Sensory Integration-Motor (SOSI-M)

Gustavo Reinoso, PhD, OTR/L

Stacy Frauwirth, MS, OTR/L

Erna Blanche, Ph., OTR/L, FAOTAS

This short course will discuss a new standardized, nationally normed assessment of sensory-motor abilities. The SOSI-M focuses on motor planning and postural control skills. Information includes different psychometric properties, guided reasoning for differential diagnosis, and their application in contemporary clinical practice.

OBJECTIVES: Identify current formal and informal approaches to assessing sensory-based motor skills, including strengths and limitations of existing tools. Discuss the development of a new nationally normed assessment for children with sensory integration and processing difficulties, the SOSI-M. Discuss the use of the SOSI-M in diagnosing sensory motor issues in children with specific sensory integration and processing difficulties.

WS-18
Sun. 2 PM
OCEANS 9

INTERMEDIATE
FIELDWORK

Incorporating Evidence-Based Practice (EBP) into Fieldwork Experiences

Helene Lieberman, MS, OTR/L

Lora May Swart BSAS, COTA/L

This workshop presented by clinicians, and Academic FW Coordinators provides information on using

Evidence Based Practice (EBP) for the student and the fieldwork educator (FWE). The levels of EBP and the benefits of EBP will be reviewed. The rationale to incorporate EBP into fieldwork and resources and strategies to incorporate EBP will be provided.

OBJECTIVES: Define and articulate the benefits of Evidence-based Practice. Identify sources to locate scholarly literature and understand information including the quality of the source of information. Ability of the FWE and FW student to use evidence-based practice decisions in Fieldwork.

WS-19
Sun. 2 PM
OCEANS 10

INTERMEDIATE
GERN/WELL/MT

Best Practices within Occupational Therapy for the LGBTQ+ Community

Amanda Kotolski, PhD, OTR/L

It is estimated that 3-5% of the US population identifies as LGBTQ+. The LGBTQ+ community has its own particular physical and mental health needs. With our

ever-evolving society, it is important occupational therapists understand and integrate culturally sensitive LGBTQ+ interventions.

OBJECTIVES: To be able to identify appropriate LGBTQ+ terminology. Identify strategies to implement and assure LGBTQ+ clients confidentiality and address special circumstance concerns. To be able to identify and implement LGBTQ+ sensitive treatment techniques in the practice.

WS-20
Sun. 2 PM
OCEANS 11

INTERMEDIATE
GERONTOLOGY

Skilled Maintenance: How to Identify the Need and Effectively Document the Skill

Reda Shihadeh, OTR/ L

Angela Edney, MSA, OTR/L , National Clinical Director

Achievement of long-term goals is often seen as the end of skilled OT services. However, there are times when

maintenance of function is so inherently complex that continued skilled care is required. We will provide the hands-on opportunity to develop the ability to identify clinically appropriate patients, and to create defensible documentation.

OBJECTIVES: Describe the Medicare regulations that govern the provision of skilled maintenance in Occupational Therapy. Identify patients who are appropriate for skilled maintenance. Develop the key elements of documentation to support the claim.

WS-21
Sun. 2 PM
OCEANS 12

INTERMEDIATE
ADMN-MGMT

Starting a Niche Emerging Practice 101: Steps to Plan, Market, and Grow

Kay Richardson, OTA/L

Making the transition from OT employee to entrepreneur can be daunting. This workshop will explore a framework to launch a cash-based niche practice. We will discuss

several OT Niche Practice case studies, the basics of starting a niche practice, and marketing, At the conclusion of this workshop, we will develop a basic 1-page business plan canvas.

OBJECTIVES: Explore three OT entrepreneur case studies to understand the elements required to start an emerging practice area business and review practical examples of what it means to think like an entrepreneur. Understand key components to apply when launching a new emerging practice business using a 1-page business plan canvas with a lean startup approach. This workshop will provide strategies and resources to address the challenges in marketing and advertising and provide opportunities for collaborative discussion.

SC-1
Sat. 10 AM
OCEANS 9

INTERMEDIATE
GERONTOLOGY

I See You! Practical Solutions to Address Low Vision in Older Adults

Cheryl Haynes, OTR/L, ATP

Leah Baynard, OTD, OTR/L

This course offers a review of the common visual impairments in geriatrics. It also addresses the utilization of standardized and non-standardized vision testing performed by occupational therapy practitioners and ophthalmologists to select more effective interventions to increase the independence and safety of older adults with visual impairments.

OBJECTIVES: Identify four common visual impairments and their effect on occupation in the geriatric population. Identify standardized and non-standardized testing for visual impairments in geriatrics. Identify cost effective solutions to incorporate in therapy interventions.

SC-2
Sat. 10 AM
OCEANS 10

INTRODUCTORY
WELLNESS

Surgical Scars: Their Influence on Pain and Health

Kelly Armstrong, OTR/L, SIPT, MPP, PhD

This presentation will introduce the concepts of Scar Release Therapy which reduces scar tissue, softens fascia, increases ROM, reduces pain, and improves function

but also has a relationship to stress and Heart rate Variability. This speaker will describe the hidden dangers scars produce and offer a scientific solution.

OBJECTIVES: Identify role and influence of scars have on and the nervous system regulation, fascia and chronic PAIN. Identify the relationship between the location of physical scars and location of chronic pain throughout the body. Identify how scars may negatively influence Occupational Therapy outcomes

SC-3
Sat. 10 AM
OCEANS 11

INTERMEDIATE
EDUCATION

Innovative and Collaborative Level I Fieldwork Experiences

Sheri Montgomery, OTD, OTR/L, FAOTA

Limited literature supports simulation as a tool enhancing student's knowledge to practice in preparation for level II FW. Concepts related to innovative approaches for level I FW preparing students for real-world clinical experiences for level II FW will be discussed. Digital, simulated, & faculty lead experiences will be explored and experienced.

OBJECTIVES: Identify, apply, and evaluate appropriate innovative level I fieldwork experiences to support students integration and application of knowledge to real-world experiences. Identify appropriate use of innovative level I FW experiences by linking learning objectives and pedagogy to maximize student success and integration of knowledge.

SC-4
Sat. 10 AM
OCEANS 12

ADVANCED
GERONTOLOGY

Improving visibility of occupational therapy while collaborating in home health – Challenges within and outside of home health companies

Prerna Poojary Mazzotta, PhD, OTR/L, CLWT

Danyell Daughtery, RN

Community dwelling adults have complex needs increasing challenges in quality of life. This session may help advance patient care by increased visualization of OT to assist with enhanced patient care, interdisciplinary collaboration and focus on client centered specific needs.

OBJECTIVES: Understand various dynamics associated with interdisciplinary collaboration in home health and hospitals. Articulate the role of occupational

SHORT COURSES

therapy in enhancing patient care outcomes while collaboration with other disciplines in a home health setting. Understand the specific skills of occupational therapists that are vital towards the success of an interdisciplinary treatment program in a transitional memory care unit.

SC-5
Sat. 10 AM
VEILTAL

INTERMEDIATE
EDUCATION

The Mentorship Experiences of Occupational Therapists who have Attained Certification in Hand Therapy

Katherine Greg, OTD, OTR/L

Dr. Belkis Landa-Gonzalez EdD, OTR/L, FAOTA

This study explores mentoring models used by CHTs

to help them achieve certification. There is no formal training or mentoring towards this process. This study consists of a nationwide survey sent to CHTs. Mentorship models and strategies for certification are discussed. Findings may help training and enhancing curriculum towards certification.

OBJECTIVES: Identify prevalent mentoring models and learning strategies utilized by occupational therapists in achieving hand therapy certification. Identify the barriers associated with achieving hand therapy certification. Discuss how the findings of this study can aid in improving the certification process for occupational therapists as well as recommendations for OT clinical and academic educators.

SC-6
Sat. 1 PM
OCEANS 9

INTERMEDIATE
GERONTOLOGY

Guidelines for Billing and Reimbursement for Private OT

Cheryl B. Model, Otr/L

I will address the guidelines for Billing and Reimbursement for private OT practitioners using Medicare, other insurances and private payments. I will also discuss documentation, CPT codes, and billing: How to keep track of your payments, what to do about denials, my personal experiences and how it relates to the topics. OBJECTIVES: Learn guidelines for billing and reimbursement for private OT practitioners. Learn how to document and bill using correct codes and modifiers to get most payments without denials. Learn what to do if you get denied as I did and won appeal from ALJ.

1. Graduate of Columbia University, College of Physicians and Surgeons, Occupational Therapy Program 2. Clinical Director of OT for Miami-Dade several SNFs 3. Rehab Director of 3 SNFs 4. OT Supervisor at large hospital 5. Taught Prosthetics and Orthotics at FIU OT program 6. President/Sole Proprietor of Model Wellness, Inc. for last 20 years being a Medicare, private pay, and insurance provider.

SC-7
Sat. 1 PM
OCEANS 10

INTERMEDIATE
GERONTOLOGY

Forging a Community Partnership to Support Caregivers of Individuals Living with Alzheimer's Disease

Hector Huerta, OTD, MS, OTR/L

Alma Abdel-Moty, Dr.OT, MS, OTR/L

Informal caregivers are frequently unprepared for the challenges of assisting loved ones with dementia.

Presenters will disseminate information regarding effective strategies to develop community partnerships that provide education to caregivers. Presenters will provide strategies to forge collaborations that enhance healthy communities. OBJECTIVES: Describe the learning objectives of a therapist-lead workshop to educate informal caregivers of individuals living with Alzheimers Disease Identify factors that promote the development of a collaborative educational module. Identify methods to neutralize factors that hinder effective collaboration with community partners during the implementation of a collaborative educational module.

SHORT COURSES

SC-8 Using Essential Oils in Various Therapy Settings

Sat. 1 PM
OCEANS 11

INTRODUCTORY
WELLNESS

Rachel Griffin, COTA
Paul Lopez COTA

This course will focus on the topics of: An introduction and general understanding of what essential oils are. The benefits of using essential oils in different therapeutic settings. The correlation between essential oils and Occupational Therapy, and their approaches to client specific treatments.

OBJECTIVES: Have an understanding of what essential oils are. How to use essential oils. Identify the benefits of appropriate usage of specific oils for individual patients.

SC-9 Advancing Your Practice for Intervention with Autism Using a Communities of Practice Model

Sat. 1 PM
OCEANS 12

INTRODUCTORY
SCHOOL SYSTEMS

Carol Just, OTD, OTR/L

Communities of Practice (CoP) are groups of people driven to learn about a common topic. Intervention with individuals with ASD is challenging. In this short course, participants learn to form your own CoP, identify interactive platforms to share knowledge, and use Autism-specific evidence-based tools to improve your daily practice.

OBJECTIVES: Understand how a Communities of Practice (CoP) model can facilitate the implementation of evidence-based services for individuals with Autism. Learn how to select tools, on-line platforms, and evidence-based resources to foster collaboration, and knowledge translation. Create your own CoP based on models presented during this session.

SC-10 SOTA Leaders Networking

Sat. 1 PM
TARPON A/B

INTRODUCTORY
EDUCATION

Linda Struckmeyer, PhD, OTR/L
Corinne Hutchison, OTS
Ana Ghislandi, SOTA president

This short course include a presentation on increasing student involvement and leadership opportunities within local, state, and national OT organizations. Student occupational therapy association officers will then have the opportunity to share leadership ideas and network with other OT student leaders. SOTA faculty advisors are welcome to attend.

OBJECTIVES: Student occupational therapy association officers and SOTA faculty advisors will: Identify 3 methods for increasing student involvement. Identify local SOTA roles in FOTA and AOTA. and Network with other Florida SOTA officers.

SC-11 Group process for Supporting Occupations of College Students with Learning Disabilities & Attention-Deficit/Hyperactivity Disorder: Lessons Learned

Sat. 4:30 PM
OCEANS 9

INTRODUCTORY
DVL.P. DISABILITIES

Consuelo Kreider, PhD, OTR/L
Sharon Medina, MOT, OTR/L
Jianne Apostol, BS
Mackenzi Slamka, BS

College students with learning disabilities and ADHD report difficulties with stigma, coursework, interactions with professors, and having more non-academic and skill-based challenges. We will present implementation of our psychoeducational group approach for supporting occupational performance and lesson learned in implementing interventions.

OBJECTIVES: will be able to review and reflect on skills needed for effective facilitation of group process with older adolescents and emerging adults as they transition into new adult roles and contexts. At the conclusion of the session, participants will be able to describe and discuss the knowledge, skill, and strategies used by college students with ADHD and/or learning disabilities in college contexts. At the conclusion of the session, participants will be able to identify and discuss pragmatic considerations in communicating, scheduling, and setting up psychoeducational group sessions for young people with ADHD and/or learning disabilities.

SC-12 Creating a Roadmap for Disaster Preparedness and Management at Home and Beyond

Sat. 4:30 PM
OCEANS 10

INTRODUCTORY
EDUCATION

Susan Skees Hermes, OTD, OTR/L, BCP

Participants will reflect on personal and professional skills and knowledge they bring to disaster preparedness and management within the client evaluation, treatment planning, and community factors, as indicated. Participants will create a personal plan for participation in at home, community, and state levels related to their interests. OBJECTIVES: Identify personal and professional skills that participants can use in disaster preparedness and management within client evaluation, treatment planning, and their communities. Create a plan of action to assist with disaster preparedness and management within their professional toolbox and communities.

SC-13 Finding our way Back into Mental Health: A Level 2 Fieldwork Experience

Sat. 4:30 PM
OCEANS 11

INTERMEDIATE
MENTAL HEALTH

Christine Moghimi, ScD, MAS, OTR/L
Amy Protheroe, MOT student, 2nd year

In the practice of mental health, the roots of our profession, it is a strange experience to consider a Level 2 placement in an acute mental health setting as "non-traditional" (No OT present). This presentation offers a student/faculty narrative and discussion of challenges/opportunities in bringing OT back to this setting and reclaiming our roots.

OBJECTIVES: Be able to compare and contrast their own mental health practice experiences with the presentation material. Be able to assess OT's role in current mental health inpatient facilities. Be able to develop strategies for inter-professional collaboration in determining OT's role with this population.

SC-14 3D Printing the Rehabilitation Clinic

Sat. 4:30 PM
OCEANS 12

INTRODUCTORY
TECHNOLOGY

Sandra Salinas, OTR/CHT, MHS
Mariana D'Amico EdD, OTR/L, BCP, FAOTA

OT's are, by nature, makers
OBJECTIVES: Learn basic terminology for understanding the process of 3D printing. To be able to identify three ways that 3D printing can be used in the therapy clinic. Learn how to find 3 D printed models on the web for use with clients.

SC-15 Concepts and Considerations for Aging in Place (AIP)

Sun. 8 AM
OCEANS 1-3

INTRODUCTORY
GERONTOLOGY

Carlos Martoral, OTD, JD

Designed to introduce participants to AIP, this short course will examine common challenges amongst three groups of clientele who wish to stay in their own homes. Those not experiencing health issues related to aging, those with a condition that requires home modification, and those dealing with an abrupt or traumatic health-related change.

OBJECTIVES: Identify modifications and adaptations to a home environment that promote safety and function in the AIP space. Recognize special considerations for estimating, scheduling, and executing AIP projects while the client is still in the home. Distinguish the categories of design and how they relate to the various AIP segments.

SC-16 Occupational Therapy and Vision Impairment in the School System

Sun. 8 AM
OCEANS 9

INTRODUCTORY
SCHOOL SYSTEMS

Margaret Beckley, PhD, EdS, OTR/L, SCLV, COMS

This course presents the typical eye conditions that cause low vision impairments for school-aged children and strategies to manage the impact of these impairments. Topics to be covered include low vision diagnoses, evaluation, use of optics, lighting, contrast, & distance, optimal positioning, mobility and safety.

OBJECTIVES: To be able to describe the impact a visual impairment can have on student safety and performance. Identify strategies that can be used to decrease the impact of a low vision impairment on a students performance in school-based occupational therapy. Report how to use resources and find additional services for a student with a visual impairment.

SC-17 Medicare Coverage of Maintenance Therapy: A Blueprint for Best Practice

Sun. 8 AM
OCEANS 10

INTERMEDIATE
ADMN-MGMT

Connie Sakellaropoulos, MOTR/L

While Medicare's clarification of the No Improvement Standard brought a collective public sigh of relief from patient advocacy organizations, many therapists do not provide maintenance therapy care for patients due to fear of a TPE. This course reviews best practices that have had proven success in providing maintenance care for patients.

OBJECTIVES: Understand the history of Medicare's No Improvement Standard and core differences between rehabilitative and maintenance therapy care. Provide guidelines for how to determine which patients meet coverage criteria for on-going maintenance therapy care. Create a blueprint for documentation of a maintenance therapy program to reduce risk for claim denial.

SC-18 Let's Talk about the NBCOT® National Certification Exam!

Sun. 8 AM
OCEANS 11

INTRODUCTORY
EDUCATION

Barbara Williams, DrOT, MS, OTR

This presentation will provide information on preparing for the NBCOT national certification examination, as well as the examination application process and the benefits of certification.

OBJECTIVES: Understand the national certification examination application process. Learn about exam preparation resources including the NBCOT Aspire® Study Tools and StudyPack. Increase awareness of NBCOT and the importance of continuing competency

SHORT COURSES

SC-19 OT in Cardiac Rehab – A Functional Approach

Sun. 8 AM
OCEANS 12

INTERMEDIATE
PHYSICAL DISABILITIES

Nadya Ramos Hernandez, OTDS, COTA
Jennifer Kearns, OTDS

An increasing of hospitalizations for cardiac-related conditions within the U.S. suggests cardiac rehabilitation should be a prime area of focus for rehabilitation practitioners, especially OTs. With the emphasizes on mobility and hospitalization length of stay, OT practitioners are being pushed out and/or losing focus on function within acute care.

OBJECTIVES: To advocate how OT services can be included as an independent and necessary service within a cardiac rehabilitation setting. To identify how OT can enhance evaluation, treatment/intervention and outcomes within a cardiac rehabilitative setting to decrease risk of future exacerbations or complications leading to hospital readmissions. To identify how OT practitioners can enhance a client's overall health and wellbeing utilizing their unique training, skill set and a client-centered approach.

SC-20 Perspectives on Home Modifications and the Utility of Repurposing

Sun. 1 PM
OCEANS 9

INTERMEDIATE
HOME HEALTH

Linda Struckmeyer, PhD, OTR/L
Carlyn Ellison, MPH, CPH

The purpose of this presentation is to present focus group results on problems and solutions regarding home modifications and ways consumers and professionals implement repurposing that residents deem accessible, affordable, and attractive. Questions focused on repurposed solutions in bedroom-to-bathroom transition, first-floor studio, and kitchen.

OBJECTIVES: Develop an understanding of how focus groups can inform practice and research. Identify the concept of repurposing in home modifications. Explore innovation solutions to home modifications that professionals and consumers deemed accessible, affordable and attractive.

SC-21 Adaptive Sports and Recreation as Therapeutic Occupation

Sun. 1 PM
OCEANS 10

INTRODUCTORY
WELLNESS

Alice Krauss, OTR/L
Elizabeth Pugh, MA, OTR/L, FAOTA

Individuals with disability experience physical inactivity and social isolation at a higher rate than their non-disabled peers. These conditions contribute to secondary, preventable, and costly health complications. An occupation-based sports and recreation program serves as an exemplar of emerging practice in the area of health and wellness.

OBJECTIVES: To clearly see the AOTA Vision 2025 in action and identify the pillars of effectiveness, leadership, collaboration, accessibility, and diversity in this occupation-based practice model. To be able to translate this practice model using other occupations and with other populations to promote health, well-being, and quality of life. Identify barriers and solutions to authentic occupation-centered practice.

SHORT COURSES

SC-22
Sun. 1 PM
OCEANS 11

INTERMEDIATE EDUCATION

Assessment of Students' Clinical Reasoning Skills Via Clinical Scenario Simulations with Standardized Patients
Hector Huerta, OTD, MS, OTR/L
Rebecca Mojica, MS, OTR/L
Jaclyn Schwarz, PhD, OTR/L

OT faculty will disseminate information to promote successful implementation of the assessment of students' clinical reasoning skills with simulation via standardized patients, which has been included as a valid approach for Level 1 Fieldwork by the Accreditation Council for Occupational Therapy Education (ACOTE).
OBJECTIVES: Identify strategies to assess students clinical reasoning skills via simulation using standardized patients. Describe advantages and limitations associated with the assessment of clinical reasoning skills via simulation using standardized patients. List resources that support the assessment of clinical reasoning skills via simulation using standardized patients.

SC-23
Sun. 1 PM
OCEANS 12

INTERMEDIATE GERONTOLOGY

Enhancing Quality of Life for Clients with Dementia and Their Caregivers
Brigitte Belanger, OTR/L, DSc, AAT(c)

This presentation is intended to offer clinicians insight into the use and value of the Allen Cognitive Levels Screen to help guide caregivers of clients with dementia.
The course will focus on sharing practical and concrete occupational therapy suggestions intended to allow caregivers to develop a safe and productive living environment.
OBJECTIVES: Attendees will learn to help caregivers develop realistic and relevant goals with clients using the Cognitive Disabilities Model. Attendees will strengthen their understanding of techniques to use for errorless learning. Attendees will receive innovative intervention ideas to share with caregivers and clients.

SC-24
Sun. 3 PM
OCEANS 1-3

INTERMEDIATE EDUCATION

Using Patient Decision Aids and Personal Decision Guides in OT Practice
Elise Bloch, EdD, OT/L

This session will introduce clinicians to the use and appraisal of patient decision aids and personal decision guides to use when working with clients and their families. These instruments are considered essential for best practice.
OBJECTIVES: Participants will delineate the use and importance and patient decision aids and personal decision guides in current OT practice. Participants will describe the appraisal parameters for patient decision aid. Participants will develop a personal decision guide for a case study.

CONVERSATIONS that MATTER

CTM-1
Sat. 8 AM
TARPON A/B

INTERMEDIATE GERONTOLOGY

Executive Order and OT Implications for Veteran Suicide: Part II
Anjali Parti, OTD, OTR/L
Annette Bullard, COTA/L, AFWC

At the Florida Occupational Therapy Association (FOTA) conference in 2018, Anjali Parti and Annette Bullard hosted a Conversations that Matter that was very well attended. We have decided to re-visit this important topic due to President Trump's recent Executive Order signed March 5, 2019.
OBJECTIVES: Increased understanding of what the Executive Order entails. What does it mean for OT/OTAs practicing in the field? Financial and community support and legal questions answered on how we can utilize this support for advocacy efforts.

CTM-2
Sat. 9 AM
TARPON A/B

INTERMEDIATE HOME HEALTH

Best Practices for Supporting the LGBTQ+ Community in the Home and Community Practice Setting
Amanda Kotolski, PhD, OTR/L

People who identify as LGBTQ+ are members in every community, include all races and ethnicities, all ages and socio-economic statuses; however usually under identified in healthcare. Join us for a discussion on best practices to ensure appropriate, safe, and empathetic care with our LGBTQ+ clients.
OBJECTIVES: At the conclusion of this session, participants will be able to identify and implement LGBTQ+ advocacy techniques in the practice. At the conclusion of this session, participants will be able to identify appropriate LGBTQ+ terminology. At the conclusion of this session, participants will be able to identify strategies to implement and assure LGBTQ+ client's confidentiality and address special circumstance concerns.

CTM-3
SAT. 10 AM
TARPON A/B

INTRODUCTORY OCC. SCIENCE

Is Cyberbullying an Occupation towards Social Participation?
Ricardo Carrasco, Phd, OTR/L, FAOTA
Mariana D'Amico, EdD, OTR/L, FAOTA

This "Conversations" will enhance awareness about the violent dark occupation called cyberbullying and understand why individuals engage in it. Hosts will facilitate discussions about the engagement and motivation for cyberbullying as entertainment, fun, social connection and conformity to social expectations.
OBJECTIVES: Describe the difference between well and dark occupations. Recognize the mechanism of engagement both as perpetrator or recipient of cyberbullying. Consider education and religious engagement in relation to cyberbullying

CTM-4
SAT. 2 PM
TARPON A/B

INTERMEDIATE WORK PROGRAMS

Occupational Burnout: Awareness for HealthCare Professionals
Regina Bonyngge, OTR/L, CEAS II
Tammy Barnett

For today's healthcare providers the common expectation is to work long hours, accomplish everything while advancing to the top. These high achievers living with high expectations, sadly experience burnout unexpectedly. Experts believe this chronic job stress, yet to have a medical diagnosis, is behind a multitude of negative health conditions.
OBJECTIVES: Understand and recognize the 3 dimensions of burnout which includes overwhelming physical and emotional exhaustion, detachment from job responsibilities with an over cynical mindset, and feelings of inadequacy with

reduced accomplishment. Be able to explore and apply the 6 key risk factors that accompany the experience of burnout which is helpful for prevention and to identify whether the presence of active burnout exists. Discover next steps to begin moving forward out of burnout and implementing strategies immediately to improve quality of occupational and personal life.

CTM-5
Sat. 3 PM
TARPON A/B

ADVANCED FIELDWORK

Student Accommodations on Fieldwork
Linda Struckmeyer, PhD, OTR/L
Heidi Horwitz, OTD, OTR/L

This SIS Conversation that Matters will focus on student accommodations during Level 2 fieldwork experiences. Participants will have the opportunity to gather resources and share what accommodations have been successful for fieldwork students. This discussion session is for both academic fieldwork coordinators and fieldwork educators.
OBJECTIVES: Discuss and share resources for obtaining information about student accommodations on fieldwork. Discuss and share accommodations that have been successful for their students.

CTM-6
Sat. 4:30 PM
TARPON A/B

INTERMEDIATE RESEARCH

The Role of Research in Validating Occupational Therapists as Qualified Mental Health Providers
Annemarie Connor, PhD, OTR/L
Sarah Fabrizi, PhD, OTR/L

As a reemerging practice area, few OTs currently work in mental health (MH) settings and only five states list OTs as qualified mental health providers. In this Conversation that Matters, we will discuss the current state of MH research and OT interventions that may bolster perceptions of our legitimacy and efficacy as qualified mental health providers.
OBJECTIVES: Participants will learn/discuss/share strategies for developing theory-driven, evidence-based, MH interventions using occupationally-based approaches; testing such interventions among specific MH populations throughout the lifespan, and creating additional OT-led psychosocial training opportunities for students.

CTM-7
SUN. 8 AM
TARPON A/B

INTRODUCTORY TECHNOLOGY

Dialogue Exploring the Research on – Whether we Should be Using off-the-shelf Gaming Consoles to Complement Occupational Therapy
Rick Davenport, PhD, OTR/L

Off-the-shelf gaming consoles (e.g. Nintendo Wii, Xbox) have been sporadically incorporated as an innovative and complimentary intervention in rehabilitation. The presenter will have a grassroots discussion exploring the research on using off-the-shelf gaming consoles to complement occupational therapy.
OBJECTIVES: Expand their knowledge about the research evidence that supports the use of off-the-shelf gaming consoles as a component of rehabilitation therapy. Identify current practices of off-the-shelf gaming consoles being utilized in practice settings across the state of Florida.

CTM-8
Sun. 9 AM
TARPON A/B

INTERMEDIATE ADMN-MGMT

Insurance Fraud & Unethical Billing
Michael Steinhauer, OTR/L MPH, FAOTA

Productivity is the measurement standard by which most OT services are quantified and it reflects workload expectations. Practitioners have a duty to critically exam-

CONVERSATIONS that MATTER

ine whether productivity expectations by the organization are congruent with published OT codes of ethics, legal standards, and payer requirements.
OBJECTIVES: Participants will be able to identify examples of unreasonable or unethical productivity expectations of the practice setting. Learn to apply ethical decision making strategies to address the gap between facility productivity expectations and reasonable clinical practices. Learn to become familiar with the AOTA Code of Ethics, the AOTA Organizational Code of Ethics, and other professional standards that will arm practitioners with a defense against unreasonable productivity demands.

CTM-9
Sun. 10 AM
TARPON A/B

INTRODUCTORY PHYSICAL DISABILITIES

Occupational Therapy and Cancer Care
Kristin Domville, MOT, OTR/L

Evidence support rehabilitation programs that enhance the quality of life among individuals diagnosed with cancer. Occupational therapy is beneficial for improving everyday function and participation in daily life activities regardless of the type and stage of cancer.
OBJECTIVES: Identify the benefits of OT intervention among cancer patients. Articulate the valuable role occupational therapy has within cancer care across the continuum. Identify barriers that may be limiting occupational therapists in cancer care.

CTM-10
Sun. 1 PM
TARPON A/B

INTRODUCTORY MENTAL HEALTH

Trauma and Trauma-Informed Approaches to Care: Applications to Occupational Therapy Practice
Mirtha Whaley, PhD, MPH, OTR/L

Trauma's profound effects are lifelong. Awareness has improved for childhood trauma and PTSD but not for other forms of trauma and populations. Trauma-informed approaches are congruent with OT values and principles. This presentation raises awareness of trauma-informed care to promote a discussion of its application across practice settings in OT.
OBJECTIVES: At the conclusion of this presentation, participants will be able to define trauma and trauma-informed care; discuss the effects of trauma on function and individuals' participation in valued roles and occupations and propose how knowledge of trauma and trauma-informed (TIC) care are congruent with occupational therapy values and principles and apply TIC to OT practice across age groups and OT practice settings.

CTM-11
Sun. 2 PM
TARPON A/B

INTERMEDIATE EDUCATION

The Value of a the Mentor Role in Developing Professional Behaviors in Students
Kurt Hubbard, PhD, OTD, OTR/L, FAOTA

Professional behaviors are foundational to excellence in client-centered OT practice and to attaining AOTA's Vision 2025. Examining the importance of the educator's role as mentor and to select evidence-based strategies for successful student attainment of professional behaviors is paramount.
OBJECTIVES: Identify professional behaviors that provide appropriate role modeling for students. How to disseminate the process of role modeling to faculty. Identify the strategies for effective role modeling and reflective practice.

PROFESSIONAL POSTERS

SATURDAY SESSION 1

PRESENTATION 2:00 - 3:00 PM • OCEANS 4

The Distinct Role of Occupational Therapy in Driver Rehab: A Scoping Review

Cindy Erb, OTD, MSH, OTR/L, CNDT, CLT

SIS: Admn-Management, Education, Physical Disabilities

LEVEL: Introductory

The 35 articles selected for this scoping review indicate occupational therapy's inclusive understanding of the complexities of driver rehab and ability to understand, assess, and address the inter-related component skills required to drive. OBJECTIVES: Identify OT as the distinct profession in driver rehab.

Fieldwork Educators' Communication of Their Clinical Reasoning Skills and Occupation-Based Practice Models to Their Students

Heidi Horwitz, MEd, OTD, OTR/L

SIS: Fieldwork

LEVEL: Introductory

This study explored clinical reasoning and OBP models that fieldwork educators communicate to students. It looked at fieldwork educators' use of think aloud, reflection on action and thinking frames. Participants will learn strategies for making clinical reasoning more explicit. OBJECTIVES: To identify types of clinical reasoning and occupation-based practice models that fieldwork educators communicate with their fieldwork students. Learn to describe how fieldwork educators communicate about clinical reasoning and occupation-based practice models to their students. Learn about communication strategies that can be used to communicate clinical reasoning to their students.

Role Participation and Quality of Life in Individuals with Hand Osteoarthritis: an Occupational Therapy Perspective

Kellie Wing, OTD, MS, OTR/L

SIS: Gerontology, Wellness

LEVEL: Intermediate

Despite lacking a statistically significant relationship between role participation and quality of life scores it bears noting that occupational therapy is uniquely poised to bridge the gap of education and advocacy to maintain healthy physical, emotional, and social participation which is supported in the literature to enhance quality of life. OBJECTIVES: Participants will be able to articulate the role of occupational therapy in quality of life issues and offer support for that role in an interdisciplinary setting. Participants will be able to articulate the occupational therapy perspective in supporting role participation for improved quality of life.

Automated Vehicle Survey Design: Looking at face and Content Validity

James Wersal, OTD, MSOT, OTR/L, CBIS

Justin Mason, PhD

Sherrilene Classen, PhD, MPH, OTR/L, FAOTA, FGSA

Virginia Sisiopiku, PhD

SIS: Research

LEVEL: Introductory

Automated vehicles (AVs) may provide numerous societal benefits, including reducing road fatalities, improving participation, and equity of services. The aim was to design a survey that would assess users' perceptions of AVs. Although further validation is required, this survey may provide insight into users' perceptions of AVs. OBJECTIVES: Understand the process for assessing face and content validity in

the survey design. Summarize the findings and demonstrate an uptake of the findings for practical application.

SUNDAY SESSION 2

PRESENTATION 1:00 PM - 2:00 PM • OCEANS 4

Squiggles and Wiggles: An Interprofessional Blog for School-based Service Providers

Patricia Palomar, OTD, OTR/L

SIS: Research

LEVEL: Intermediate

The poster studies the use of a blog to develop an interprofessional community of practice for school-based service providers. This platform to facilitate collaboration, reflective practice, lifelong learning, and professional development. As the followers apply the evidence, their interventions will promote the students' occupational performance. OBJECTIVES: Obtain information on the benefits and use of an online blog to facilitate interprofessional collaboration for school-based service providers (occupational therapists, physical therapists, speech pathologists, school psychologists, and special education teachers). Analyze data from pre- and post-surveys of participants to determine the effectiveness of an interprofessional blog. Apply information to support lifelong learning in occupational therapy and the importance of interprofessional collaboration.

Development of the DynEx Dynamometer Handle Adapter for Children

Marcia Schneider, MHS, OTR/L

Christine T. Myers, PhD, OTR/L

Orit Shechtman, PhD, OTR/L

SIS: Research

LEVEL: Intermediate

The gold standard tool for measuring grip strength, the Jamar dynamometer, is heavy, bulky, and large for a child's small hands. In contrast, the DynEx dynamometer is lighter, smaller, and has a new child's handle adapter, providing narrower and more gradual handle-positions. We ran a pilot study to test the suitability of this device for children. OBJECTIVES: Explain how grip strength measurements in children are influenced by testing with an unsuitable instrument. Describe how anthropometric measures such as hand size are utilized in the design of grip strength testing instruments. Elucidate why the DynEx Dynamometer's handle adapter makes it well-suited for testing grip strength in children.

The Role of Occupational Therapy in Cancer Rehabilitation: A Survey of the Perspectives of Occupational Therapy Clinicians from Puerto Rico

Deirieris Mendez, OTD, OTR/L

Stanley Paul, PhD, MD, OTR/L

SIS: Research

LEVEL: Intermediate

A survey was conducted with the Occupational Therapy practitioners in Puerto Rico. Results of the study provided valuable information to practitioners, educators and researchers on the role of OT in cancer rehabilitation as well as the opportunities and challenges we face in the care of this important patient population. OBJECTIVES: To understand occupational therapy practitioners' knowledge of cancer care in Puerto Rico. To understand the perceptions of occupational

therapy practitioners about the role of OT in Cancer Rehabilitation in Puerto Rico. To identify and capture the services of Occupational Therapy in cancer rehabilitation in Puerto Rico.

A Scoping Review for Smart In-Vehicle Technologies and Older Drivers

Mary Jeghers, OTR/L

Sherrilene Classen, PhD, MPH, OTR/L, FAOTA, FGSA

Jane Morgan-Daniel, MLIS, MA, AHIP

Sandra Winter, PhD, OTR/L

SIS: Technology

LEVEL: Introductory

Older drivers with age-related declines are at an increased risk for motor vehicle crashes. Researchers will present a scoping review that examined the impact - comfort, convenience, and safety - of In-Vehicle Information Systems and/or Advanced Driving Assistance Systems on the driving task (in a driving simulator or on-road) for older adults. OBJECTIVES: Learn to evaluate the benefits and challenges of In-Vehicle Information Systems and/or Advanced Driver Assistance Systems for older drivers. Participants will synthesize findings to identify how In-Vehicle Information Systems and/or Advanced Driver Assistance Systems can be used with occupational therapy assessment and intervention.

Identifying Salient Skills Used by College Students with Learning Disabilities and ADHD for Successful Occupational Performance

Sharon Medina, MOT, OTR/L

Haley Benner

Kelly Dillon

Consuelo Kreider, PhD, OTR/L

SIS: Developmental Disabilities

LEVEL: Introductory

College students with learning disabilities and attention-deficit hyperactivity disorder (LD/ADHD) encounter challenges in managing tasks during the transition to adulthood. This qualitative analysis identifies salient skills that students with LD/ADHD use and how they are implemented within various contexts for successful occupational performance. OBJECTIVES: At the conclusion of this session, participants will identify skills that college students with LD/ADHD use in various contexts for successful occupational performance. At the conclusion of this session, participants will reflect on how to develop these key skills within their OT practice.

Community-Based Occupational Therapy Practice With Older Adults: Exploring Value and Limitations

Kristin Domville, Dr.OT, MOT

Dr. Lawrence Faulkner PhD, OT

SIS: Gerontology

LEVEL: Introductory

Through engagement in occupation, community-dwelling older adults can increase their overall health, wellness, and quality of life. Access to community-based OT practice among older adults is limited. This poster explores the value that OT brings and the limitations that hinder expanding OT practice in the community with this population. OBJECTIVES: Articulate the valuable role occupational therapy has in community practice among older adults. Identify barriers that are limiting occupational therapist's in community-based practice with older adults.

PROFESSIONAL POSTERS

Picking up Traction: The "Treads" of Core Competencies of Occupational Therapy Fellowship Programs

Marcelo Silva, MA, OTR/L, BCPR

SIS: Education

LEVEL: Advanced

Evidence suggests the importance of using frameworks to guide practice for the provision of high-quality, science-driven, and occupation-based OT services. This poster will describe a framework of core competencies or "treads" (Learning, Practicing, Leading) in a lifelong journey that can be used to guide the creation of OT fellowship programs. OBJECTIVES: Describe the evidence relating to the importance of using a conceptual framework to guide the development of OT fellowship programs. Identify core domains or "treads" of essential competencies (Learning, Practicing, Leading, Lifelong Learning) for OT fellowship programs

Program Proposal for Occupational Therapy in Post-Bariatric Surgery Aftercare Program

Deborah Ruediger, OTD, OTR/L

SIS: Wellness

LEVEL: Intermediate

The focus is to create a program proposal to include occupational therapy intervention after bariatric surgery to incorporate what the clients value in their occupations into a program that builds new and healthy habits, reintegrate into their daily occupations, and modify maladaptive behaviors for long-term success. OBJECTIVES: Learn the importance of Occupational Therapy presence in the inter-disciplinary approach for clients after Bariatric Surgery. Learn to create a program proposal to include occupational therapy intervention after bariatric surgery to incorporate what the clients value in their occupations into a program that builds new and healthy habits. The goal is to integrate occupational therapy as a standard of care post-bariatric surgery to ensure the clients reintegrate into their daily occupations and modify maladaptive behaviors for long-term success.

STUDENT POSTERS

SATURDAY SESSION 1 PRESENTATION 10-11 AM • OCEANS 4

SP1-2 Comparative Case-Study Analysis: Examining Driving Error Differences Among Male and Female Veterans Post-Deployment

UNIVERSITY OF FLORIDA
STUDENT: Kasey Clark
FACULTY: Sandra Winter, PhD, OTR/L

SP1-3 Interactive Effect of Visual and Proprioceptive Disturbance to the Control of Postural Stability in Individuals with Autism Spectrum Disorder (ASD)

UNIVERSITY OF FLORIDA
STUDENT: Emily In
FACULTY: Zheng Wang

SP1-4 The Role of Occupational Therapy in Promoting Community Reintegration and Participation for Individuals in the B.O.L.D. Program

UNIVERSITY OF FLORIDA
STUDENTS: Meaghan Fitzpatrick, Allison Haines, Natalie Ford, Hannah Burch
FACULTY: Prerna Poojary Mazzotta, PhD, OTR/L

SP1-5 Assessing Reproducibility of a New Digital Device to Measure Grip Strength

FLORIDA GULF COAST UNIVERSITY
STUDENTS: Melissa Guigliano, Joanna Pijean, Shannon Miller, Kelly Crocker, Mariah Hellstrom
FACULTY: Edwin Myers, OTD, OTR/L, ATP

SP1-6 Assessing the Effect of Verbal Encouragement Versus Verbal Encouragement Withheld on Performance Output

FLORIDA GULF COAST UNIVERSITY
STUDENTS: Shannon Miller, Kelly Crocker, Mariah Hellstrom, Amanda Okada
FACULTY: Edwin Myers, OTD, OTR/L, ATP

SP1-7 The Value of OT in Community-Based Practice: Development & Implementation of a Sensory-Based Program at Dream Oaks Camp

GANNON UNIVERSITY
STUDENT: Kelsey Rogers
FACULTY: Stephanie Adams, PhD, OTR/L

SP1-9 Program Pockets - 'Addressing Social Isolation in the Geriatric Community Setting'

POLK STATE COLLEGE
STUDENT: Christy Vinson
FACULTY: Annette Bullard, COTA/L, B.A., AFWC

SP1-10 The Psychosocial Effects of Acquired Brain Injury and the Acquired Brain Injury Clubhouse Model

FLORIDA STATE COLLEGE AT JACKSONVILLE
STUDENT: Elinor Weisfeld, Grace Lopez, Sarah Atilano
FACULTY: Valerie Allison

SP1-12 Learning with Biofeedback is Equivalent to Learning with Traditional Teaching Methods

FLORIDA INTERNATIONAL UNIVERSITY
STUDENTS: Sofia Espinosa, Allison Burnett, Aretha Jester, Joyce Lozano, Bessy Vasquez
FACULTY: Jaclyn Schwartz, PhD, OTR/L

SP1-13 Healthcare Experiences of Individuals with Mental Illnesses

NOVA SOUTHEASTERN UNIVERSITY
STUDENTS: Sanela Ombasic, Angie Wiltse, Kiera Linton, Anna Kreger
FACULTY: Elise Bloch, PhD, OTR/L

SP1-14 Rubrics Cube: Multi-dimensional Factors in Developing Quality Rubrics

NOVA SOUTHEASTERN UNIVERSITY AND JACKSONVILLE UNIVERSITY
STUDENT: Kathryn Leinhauser
FACULTY: Kimberly Fahlgren, OTR/L, OTD

SP1-15 In Children with Selective Feeding Disorders, do Oral Motor Exercises Increase Variety, Texture and Volume when Combined with Sensory Interventions?

JACKSONVILLE UNIVERSITY
STUDENTS: Nicole Reiter, OTDS; Bridget Jones, OTDS; Ashley Mills, OTDS; Amanda Vargas, MOT, OTR/L
FACULTY: Megan Bewernitz, PhD, OTR/L

SP1-16 A Scoping Review: The Effect of Mindfulness on Older Adults with Stress

FLORIDA AGRICULTURAL AND MECHANICAL UNIVERSITY
STUDENTS: Sidney Llado, Kyle Bussey, Nia Henley
FACULTY: Debora Oliveira, PhD, CRC, OTR/L; Barbara Kornblau

SP1-17 The Effects of the Wilbarger Protocol on Children with Sensory Processing Deficits

KEISER UNIVERSITY
STUDENTS: Keri Baker, Ariana Villamia
FACULTY: Christina Sanford, DrOT

SP1-18 Needs Assessment for Therapy Services in the Florida Keys

FLORIDA INTERNATIONAL UNIVERSITY
STUDENTS: Sherise Hextall, OTS; Shenella Mullings, OTS; Jessica Alfonso, OTS
FACULTY: Tana Carson, PhD, OTR/L

SP1-19 Pain from Work-Related Tasks Among Cosmetologists

FLORIDA AGRICULTURAL & MECHANICAL UNIVERSITY
STUDENTS: Deshaun Squires, Miles DeWitt, Jessica Nathan, Gilliann Gray
FACULTY: Debora Oliveira, PhD, CRC, OTR/L

SP1-20 Bird Dog Boats: Facilitating Occupational Performance in Recreation Through Accessible Boating Activities

STUDENTS: Mary Bradberry, OTS; Chris Quintela, OTS; Danny Alfonso, OTS
FACULTY: Laura Sellew, OTS

SP1-21 Gaps in Senior Transition Care from Rehabilitation to Home

STUDENT: Kathleen Crooks, OTS; Rachel Wisniewski, OTS

SATURDAY SESSION 2 PRESENTATION 4:30-5:30 PM • OCEANS 4

SP2-1 Using Occupational Therapy Services to Implement a Food Education Program for Mothers in a Substance Abuse Treatment Center

UNIVERSITY OF FLORIDA
STUDENTS: Arien Hart, Kaylin Cullinane, Laura Dolmovich, Janine Legaspi, Courtney Newell
FACULTY: Prerna Poojary-Mazzotta, PhD, OTR/L

SP2-2 Planning Ahead: Using Occupational Therapy to Promote Disaster Preparedness and Continued Independence for Homebound Elderly Adults

UNIVERSITY OF FLORIDA
STUDENTS: Danielle Kleinberg, Kayla Enea, Megan Manulak, Kaylee Noon, Pooja Surkanti
FACULTY: Prerna Poojary Mazzotta, PhD, OTR/L

SP2-3 Implementing Occupation-Informed Therapeutic Principles in a Community-Based Yoga Program to Promote Wellness and Participation

UNIVERSITY OF FLORIDA
STUDENTS: Tori Tiger-Alexander, Jordan Bradford, Samantha Jenkins, Keegan Heye
FACULTY: Prerna Poojary Mazzotta, PhD, OTR/L

SP2-4 An Examination of the Efficacy of Occupational Therapy on the Psychosocial Functioning of Individuals Affected by Sex Trafficking: A Community-Based Collaborative Project

UNIVERSITY OF FLORIDA
STUDENTS: Rebecca Soodeen, Lindsey Kulchin, Emily Liou, Taylor Moore, Andrea Auld
FACULTY: Prerna Poojary Mazzotta, PhD, OTR/L

SP2-5 Feasibility of Near-Peer Delivery of a Vocational Social Skills Intervention for Young Adults with Autism

FLORIDA GULF COAST UNIVERSITY
STUDENTS: Nicole Lauria, Juliet Felsen, Rachel Kraskow, Cassidy White
FACULTY: Annemarie Connor, PhD, OTR/L

SP2-6 Animal Assisted Therapy Interventions for Clients with Dementia

FLORIDA GULF COAST UNIVERSITY
STUDENTS: Davis Vertin, Emily Summa
FACULTY: Brigitte Belanger, PhD, OTR/L

SP2-7 Perceived Benefits of Occupational Therapy Interventions in a Community Day Center for Exceptional Adults

GANNON UNIVERSITY
STUDENT: Dawn Johnson
FACULTY: Jennifer Castelli

SP2-8 The Development of an Interdisciplinary Cultural Club to Improve Cultural Awareness in the Allied Health Professions

GANNON UNIVERSITY
STUDENT: Schnaidjina Francois, Dianna Lunsford
FACULTY: Dianna Lunsford

STUDENT POSTERS

SP2-9 The Effects of Equine-Assisted Therapy on the Mental Health of Veterans

POLK STATE COLLEGE
STUDENTS: Tiffany Marrero, Alexis Lopez
FACULTY: Anjali Parti, OTD, OTR/L

SP2-10 Occupational Therapy Joins the Fight Against Parkinson's Disease: The Use of Non-Contact Boxing to Improve the Symptoms of Parkinson's Disease

SOUTH UNIVERSITY
STUDENTS: Maicely Guerra Castillo, Joanna Tryon, Caylee Watkins, Kathryn Technow
FACULTY: Dana Dixie, OTR/L

SP2-11 Teaching Occupational Therapy Students to Evaluate the Accessibility of the Physical Environment

FLORIDA INTERNATIONAL UNIVERSITY
STUDENTS: Andrea Llano, Emily Serros, Katelyn Blumenthal, Stephanie Pujol
FACULTY: Jaclyn Schwartz, PhD, OTR/L

SP2-12 Psychosocial Effects of a Soft Skills Intervention for Adolescents with Substance Use Disorder as Delivered by Near-Peers: A Second-year Pilot Study

FLORIDA GULF COAST UNIVERSITY
STUDENTS: Currie Sweeney, Samantha Steele, Jared Mosley
FACULTY: Annemarie Connor, PhD, OTR/L

SP2-13 Loss and Reintegration: A Pilot Study of Transitions in Widowhood

NOVA SOUTHEASTERN UNIVERSITY, TAMPA BAY CAMPUS
STUDENTS: Kristina Kangas, Ayesha Ali
FACULTY: Mirtha Whaley, PhD, MPH, OTR/L

SP2-14 Hand Replantation Rehabilitation Protocols for Optimal Functional Outcomes

JACKSONVILLE UNIVERSITY
STUDENTS: Sheila Norris, Erica Lyons, Tiffany Nguyen
FACULTY: Megan Bewernitz, PhD, OTR/L

SP2-15 Behavioral Interventions for Oral Intake in Pediatrics

JACKSONVILLE UNIVERSITY
STUDENTS: Shelby Auer; Marcella Price, OTDS; Brooke Whitley, OTDS; Amanda Vargas, OTR/L
FACULTY: Megan Bewernitz, PhD, OTR/L

SP2-16 The Effect of Pets on Chronic Pain

FLORIDA AGRICULTURAL AND MECHANICAL UNIVERSITY
STUDENTS: Mary Palm, April Ducasse, Adriana Staples, Brittany Bird
FACULTY: Debora Oliveira, PhD, OTR/L

SP2-17 The Impact of Weighted Blankets on Sleep and the Sensory Experiences of Autistic Adults

FLORIDA AGRICULTURAL AND MECHANICAL UNIVERSITY
STUDENTS: Librya Green, Erika Willis, Natalie Ziev
FACULTY: Debora Oliveira, PhD, OTR/L

STUDENT POSTERS

SATURDAY SESSION 2 PRESENTATION 4:30-5:30 PM • OCEANS 4

SP2-18 Leisure: Occupation and Human Necessity – Perceptions of Occupational Therapists from Public Acute Mental Health Settings in Belo Horizonte/ Brazil

UNIVERSIDADE FEDERAL DE MINAS GERAIS/ UNIVERSITY OF KANSAS MEDICAL CENTER
STUDENT: Adriana Queiroz
FACULTY: Cristiane Brito/ Lisa Mische Lawson

SP2-20 Overcome: Participation in Leisure of People with Physical Disabilities

UNIVERSIDADE FEDERAL DE MINAS GERAIS/ UNIVERSITY OF KANSAS MEDICAL CENTER
STUDENTS: Adriana Queiroz, Claudia Marcia Barbosa, Edson Jos Carpintero Rezende
FACULTY: Cristiane Miryam Drumond de Brito/Lisa Mische-Lawson

SUNDAY SESSION 3 PRESENTATION 10-11 PM • OCEANS 4

SP3-1 Refugees and Immigrants: Using Occupational Therapy to Facilitate Community Integration and Accessibility to Displaced Persons

UNIVERSITY OF FLORIDA
STUDENTS: Jamie Chavez, Joana Pernia, Tiffany Henderson, Ke'andra Clayton, Ludine Augustin
FACULTY: Prerna Poojary Mazzotta, PhD, OTR/L

SP3-2 Physical Disabilities on a College Campus: A Wellness Promotion Initiative using Occupational Therapy Interventions

UNIVERSITY OF FLORIDA
STUDENTS: Mackenzi Slamka, Jianne Apostol, Regan Hamrick, Valentina Osorio, Shelby Waldron
FACULTY: Prerna Poojary-Mazzotta, PhD, OTR/L

SP3-3 Exploration of Factors Impacting Occupational Performance Related to Productivity Expectations for Undergraduates with Learning Disabilities and Attention Deficit Disorder

UNIVERSITY OF FLORIDA
STUDENTS: Mackenzi Slamka; Sharon Medina, MOT, OTR/L; Kasey Focazio; Gerard Garvan
FACULTY: Consuelo Kreider, PhD, OTR/L

SP3-4 Growing Together: Nurturing Healthy Habits Through Integrative Occupational and Horticultural Therapy in Veterans

UNIVERSITY OF FLORIDA
STUDENTS: Melissa Shinder, Melanie Binasco, Carolina Castillo, Alex Chin, Marianne Philipps
FACULTY: Prerna Poojary Mazzotta, PhD, OTR/L

SP3-5 Promoting Parent Child Interaction and Child Social-Emotional Growth through Early Childhood Playgroups: A Program Collaboration with Early Steps

FLORIDA GULF COAST UNIVERSITY
STUDENTS: Kailey Barber, Celia Izaguirre Burke
FACULTY: Sarah Fabrizi, PhD, OTR/L

SP3-6 Relationship Between Grip and Pinch Strength and Preferred Note-Taking Method

FLORIDA GULF COAST UNIVERSITY
STUDENTS: Ana Hernandez, Danielle Hennessy-Wack
FACULTY: Lynn Jaffe, ScD, OTR/L, FAOTA

SP3-7 Supporting Educators in Jamaica to Meet the Needs of Students with Autism in an Inclusive Classroom

GANNON UNIVERSITY
STUDENT: Chauntel Fraser
FACULTY: Stephanie Adams, DHSc, OTR/L

SP3-8 Motivating Factors for Pursuit of Volunteer Leadership in a National Occupational Therapy Association

GANNON UNIVERSITY
STUDENT: Sue Ram
FACULTY: Dianna Lunsford

SP3-9 Win-Win Situation: The Benefits of Service-Learning and the Positive Impact on Educational and Community Organizations

SOUTH UNIVERSITY, TAMPA
STUDENTS: Cindy Ferdinand, Andrew Bryant, Brittney Tufts, Amanda Wolcott
FACULTY: Maria Balderas

SP3-10 Program Pockets: Addressing Feelings of Isolation in the Geriatric Community through Occupational Therapy Enhancement

POLK STATE COLLEGE
STUDENT: Emily Yates
FACULTY: Annette Bullard, BS, COTA/L

SP3-11 Impact Pillbox Customization on Device Satisfaction and Medication Adherence

FLORIDA INTERNATIONAL UNIVERSITY
STUDENTS: Yaritza Caceres, Ana Centeno, Vanesa Cruz, Jessyka Gutierrez, Nicté Orozco
FACULTY: Jaclyn Schwartz, PhD, OTR/L

SP3-12 Increasing Workforce Diversity in Occupational Therapy: Supporting Student Success

UNIVERSITY AT ST. AUGUSTINE
STUDENTS: Kniquiah Hughes, Ashley Wilson, Jodi-Anne Fletcher, Shelby Justice
FACULTY: Douglene Jackson, PhD, OTR/L, LMT, ATP

SP3-13 The Role Significance of Occupational Therapy in Women's Cesarean Postpartum Recovery Care

NOVA SOUTHEASTERN UNIVERSITY
STUDENT: Lesley Samulak
FACULTY: Thomas Decker, OTD, OTR/L

SP3-14 Social Thinking: Addressing Social Participation in Children with Disabilities

JACKSONVILLE UNIVERSITY
STUDENTS: Ashley Mills, OTDS; Shelby Auer, OTDS; Eleanor Corbett, OTDS
FACULTY: Sandra Brown, PhD, OTR/L, BCP, BCBA

SP3-15 Reduced Contrast Sensitivity and Driving Performance for Drivers 55+: A Literature Review

JACKSONVILLE UNIVERSITY
STUDENTS: Eleanor Corbett, Janine Herrera, Brooke Page
FACULTY: Megan Bewernitz, OTD, OTR/L

SP3-16 Mindful Meditation to Reduce Stress in Young Adults

FLORIDA AGRICULTURAL & MECHANICAL UNIVERSITY
STUDENTS: Priya Mistry, Gabriell Herrera, Stephen Johnson
FACULTY: Debora Oliveira, PhD, OTR/L

SP3-17 How do Autistic Adults Define and Describe Resilience?

FLORIDA A AND M UNIVERSITY
STUDENTS: Ashley Guy, Evangelina Rivera, Rachel Harrell
FACULTY: Debora Oliveira, PhD, OTR/L

SP3-18 Does Participating in Exercise Reduce Stress and Promote Life Balance in Current Master of Science in Occupational Therapy (MSOT) Bridge Students?

KEISER UNIVERSITY
STUDENT: Ashley Buck
FACULTY: Christina M. Sanford, DrOT, OTR/L

LET'S TALK
ADVOCACY &
LEADERSHIP

MIX & MINGLE

Sat, Nov. 16
5:45 p.m.
Lobby Bar

non-alcoholic
drinks provided

JOIN THE FOTA
BOARD,
LEADERSHIP
DEVELOPMENT,
GOVERNMENT
AFFAIRS &
OUR LOBBYIST
FOR DRINKS,
APPS AND
LIVELY DISCUSSION

STUDENT POSTERS

SP3-19 Tackling Barriers to Healthcare in the Transgender and Non-Conforming Community

FLORIDA INTERNATIONAL UNIVERSITY
STUDENTS: Gisela Jorge, Jose Raez, Martha Gomez, Adalys Suarez
FACULTY: Amy Paul-Ward

Region 7 South
Occupational
Therapy
Forum

FREE OT professional networking forum for the South Florida tri-county area.

Region 7 South OT Forum wishes the Florida OT Community a great conference! We continue to support our South Florida OT Community with our LEAN Mission-Leadership, Education, Advocacy and Networking.

Please check out our website and Facebook page.

Happy Conference all!

follow us on instagram @region7otforum

region 7 south OT forum group

www.region7otforum.org Email region7otforum@gmail.com

FOTA



2019

SPONSORS

GOLD SPONSORS

American Therapy Administrators of Florida
Keiser University
South University

SILVER SPONSORS

Region 7 South OT Forum

BRONZE

Concorde Career College
ITA Excels
Motivations, Inc.

EXHIBITORS

AOTPAC/AOTA
American Therapy Administrators of Florida
Barrett Medical
Center for Pain and Stress Research Ltd.
Concorde Career College
Delaware Gerontology Institute, LLC
EHRC Technologies
Exploring Hand Therapy DBA Treatment 2 Go
FLOTEC
FOTA Government Affairs
Gannon University
Get Well Feel Better, LLC
Gnarly Gnat's
Keiser University
Legacy Healthcare Services
ITA Excels
Mary Baldwin University-Murphy Deming College
of Health Sciences
Mutual of Omaha
Myomo
National Board for Certification in Occupational
Therapy, Inc. (NBCOT)
New Horizons Service Dogs
Nova Southeastern University
Young Living Essential Oils
Real OT Solutions, Inc.
Safe Mobility for Life Coalition
South University
TMC (Therapy Management Corporation)
Unlimited Motion, LLC
University of Florida
University of St. Augustine



FOTA 20 CONFERENCE
November
14-15, 2020

Renaissance Orlando at SeaWorld®
6677 Sea Harbor Drive
Orlando, FL 32821

PT | OT | SLP | Rehab Professionals

We are a National Association that unites
Independent Contract Therapists of all disciplines and private
therapy practices to learn to succeed at the business of rehab.

www.itaexcels.org

hello@itaexcels.org



The Independent Therapist Alliance

Member Benefits

- ✓ CEU-Accredited Learning Courses
- ✓ Career/Job Board
- ✓ Massive Discounts on Products/Services
- ✓ Industry News
- ✓ Social/Networking Blog
- ✓ Give Back Program
and so much more.....

Special Offer
Just for FOTA Members
& Conference Attendees



Career. Work. Life. Balance.
Learn how to be your own boss.

Are you an Independent Contractor? Do you want to be? Whether you are a student or new grad just joining the field (welcome!) or considering a career change or adding income through PRN work (raise hand here please!), there are many benefits but also many challenges to "Going Independent". Join today and learn "How to Be Your Own Boss" with our signature course that is accredited for 3 CEUs for PT, OT and SLP.

Find answers. find friends. find out more.

Meet Us in the Exhibit Hall. Join Us Online.

www.itaexcels.org

"The only thing I regret about becoming an Independent Contract Therapist is that I did not do it sooner...."

Carla S., OT

[you're going to love it here]



Members of FL APTA and FOTA received a 15% discount on our Location Courses. Select "association rate"

**# 179 The MEEKS METHOD®
Management of Spinal Pathology:
Alignment for Osteoporosis, Spinal
Stenosis, Scoliosis, Back Pain
Sara Meeks, PT, MS, GCS, KYT**



Orlando, FL
DoubleTree by Hilton
October 26-27, 2019

**# 206 Innovative Stroke and
Neurological Rehab Treatment
Approaches
J.J. Mowder-Tinney PT, PhD, NCS**



Winter Park, FL
AdventHealth
November 15, 2019

Kissimmee, FL
Osceola Regional Medical Center
July 25, 2020

**# 415 Myofascial Release Therapy...
Soft Tissue Mobilization for Pain
Management and Improved Mobility
Theresa A. Schmidt, DPT, MS, OCS**



Tampa, FL
Tampa General Hospital
April 4-5, 2020

**# 330 Sensory Systems: The Effect on
Postural Control ... Understanding and
Incorporating Sensory Strategies in NDT
Treatment
Gail Ritchie, OTR, C/NDT**

Celebration, FL
Advent Health Celebration
November 21-22, 2019

Orlando, FL
RDV Sportsplex Athletic Club
October 2-3, 2020

**# 214 Core Competencies for Traumatic Brain
Injury Rehabilitation
Sheldon Herring, Ph.D**

Kissimmee, FL
Osceola Regional Medical Center
August 15, 2020

**# 139 Current Surgical and Rehabilitation
Trends in the Advances of Joint Arthroplasty
for the Shoulder, Hip and Knee
John O'Halloran DPT, PT, OCS, ATC**

Kissimmee, FL
Osceola Regional Medical Center
September 12, 2020

**# 329 Pediatric NDT Intensive Handling
Techniques
Gail Ritchie, OTR, C/NDT**

Orlando, FL
RDV Sportsplex Athletic Club
August 21-22, 2020



Approved for FL CE Broker PT and OT CEUs

**For information visit:
www.motivationsceu.com**

LOCATOR MAP

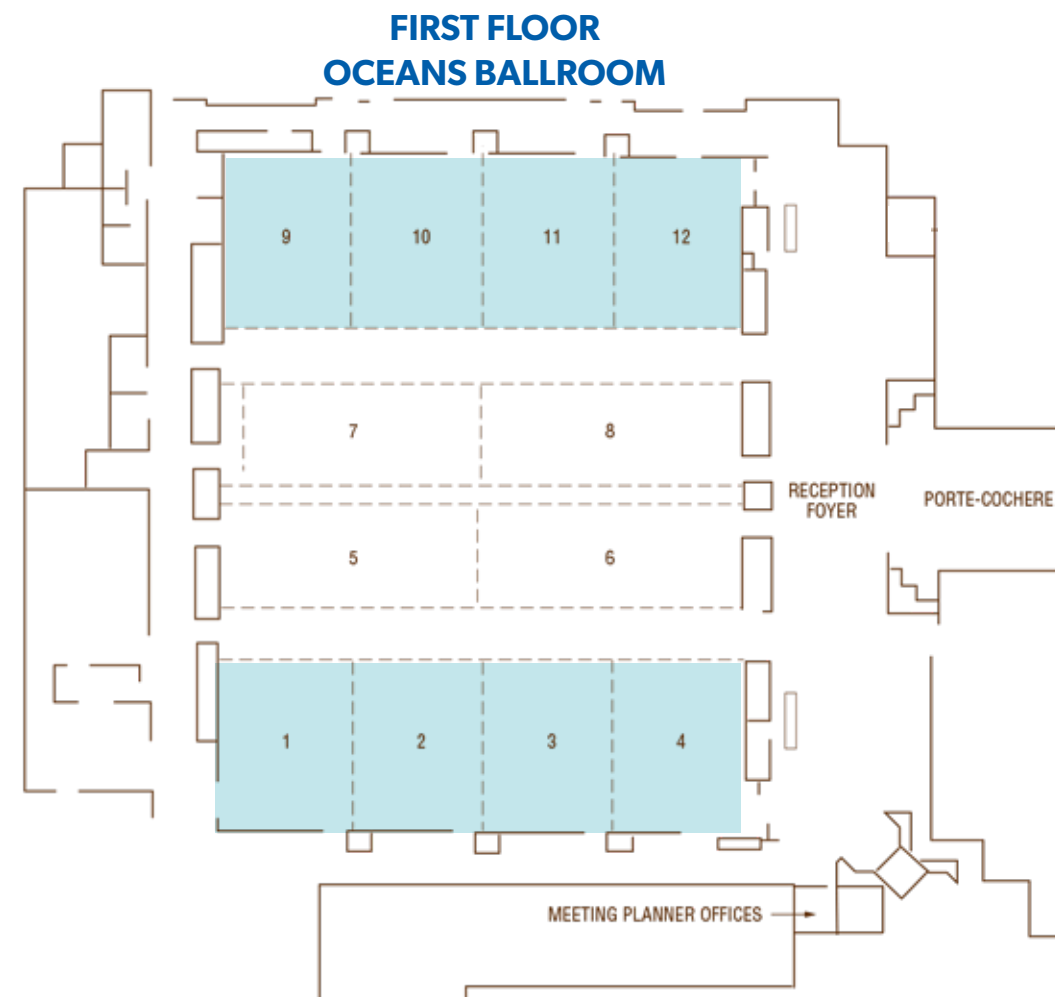

SATURDAY	SUNDAY
OCEANS 1-3: WS: 1, 6	OCEANS 1-3: WS: 12 SC: 15, 24
OCEANS 4: SP: 1, 2 PP: 1	OCEANS 4: SP: 3 PP: 2
OCEANS 9: WS: 2, 7 SC: 1, 6, 11	OCEANS 9: WS: 13, 18 SC: 17, 21
OCEANS 10: WS: 3, 8 SC: 2, 7, 12	OCEANS 10: WS: 14, 19 SC: 17, 21
OCEANS 11: WS: 4, 9 SC: 3, 8, 13	OCEANS 11: WS: 15, 20 SC: 18, 22
OCEANS 12: WS: 5, 10 SC: 4, 9, 14	OCEANS 12: WS: 16, 21 SC: 19, 23

SECOND FLOOR

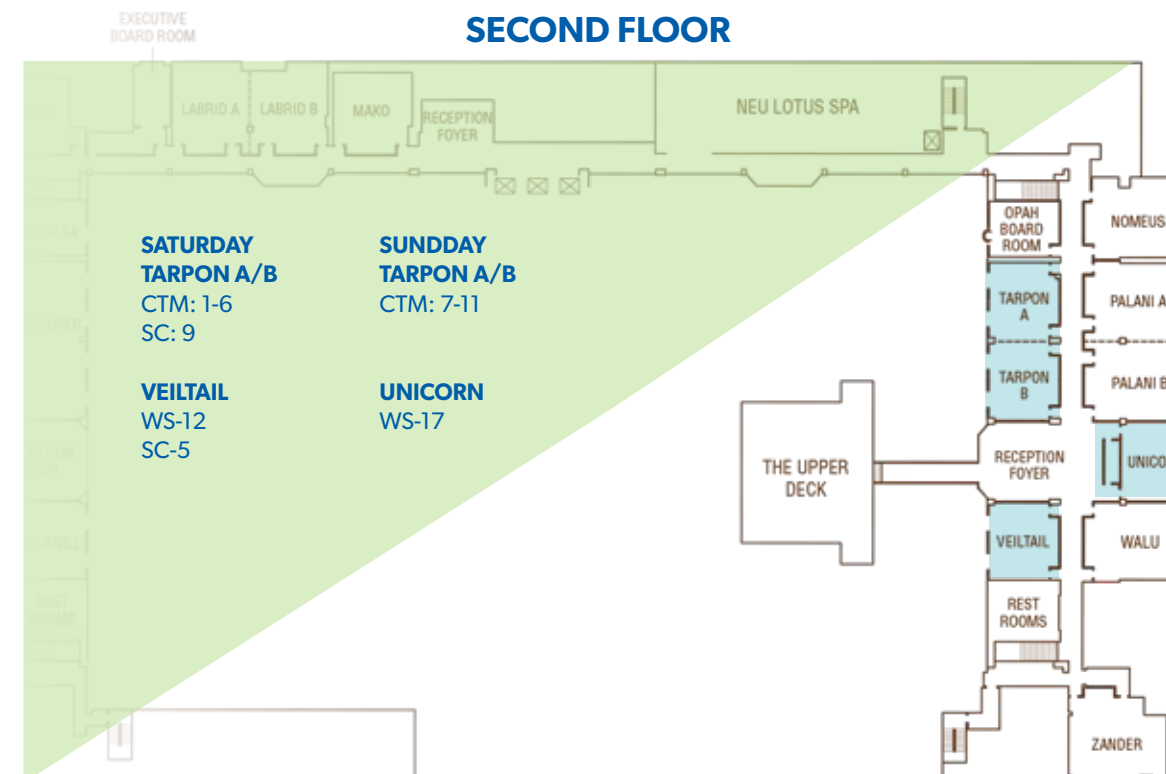

Keiser University understands that the role of Occupational Therapy is growing.



Grow with Keiser's Occupational Therapy Assistant and Master of Science in Occupational Therapy programs.

We offer a Bridge program that accepts Certified Occupational Therapy Assistants (associate level) that can bridge them to the next level in their education (bachelor to masters).

Classes are Now Enrolling.



KEISER UNIVERSITY
SEAHAWKS

KeiserUniversity.edu

Degree programs and delivery format vary by campus

